

- Ensures positive alignment between mold halves
- All sizes in stock for immediate delivery
- Hardened & Precision Ground/Finished
- Extra stock for precision fitting
- 52100 Bearing Steel
- Male 60 - 63 R/C
- Laser Marked

NEW

In Stock

1 DEGREE ANGLE
3 DEGREE ANGLE
5 DEGREE ANGLE
10 DEGREE ANGLE

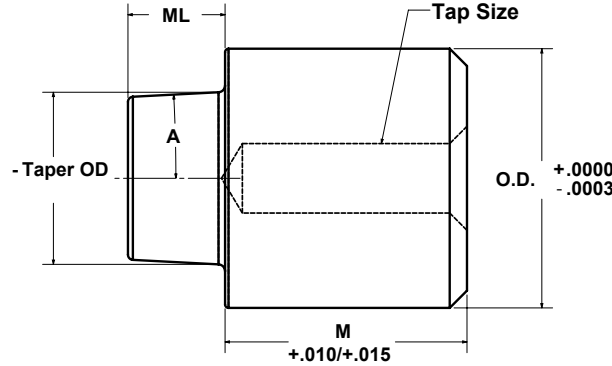

Catalog Number:

- 01 = 1 Degree Angle
- 03 = 3 Degree Angle
- 05 = 5 Degree Angle
- 10 = 10 Degree Angle

- *An Inexpensive Alternative For Straight Parting Line Locks*
- *Proudly Made in Michigan by Choice Mold Components*

OD	Taper OD	Tap Size	Taper Length ML	Male Length M	Catalog Number	Price
3/8	1/4	10-24 thread	1/4	9/16	RTM0207-10	24.25
				11/16	RTM0211-10	24.25
				7/8	RTM0214-10	24.25
1/2	5/16	10-24 thread	1/4	11/16	RTM0411-01	27.00
					RTM0411-03	26.00
					RTM0411-05	25.00
				7/8	RTM0411-10	24.00
					RTM0414-01	27.25
					RTM0414-03	26.25
				7/8	RTM0414-05	25.25
					RTM0414-10	24.25
					1-3/16	RTM0419-01
				RTM0419-03		26.50
				RTM0419-05		25.50
				1-3/8	RTM0419-10	24.50
					RTM0422-01	27.75
					RTM0422-03	26.75
				1-3/8	RTM0422-05	25.75
					RTM0422-10	24.75
					11/16	RTM0611-01
				RTM0611-03		27.00
RTM0611-05	26.00					
RTM0611-10	25.00					
RTM0614-01	28.25					
RTM0614-03	27.25					
7/8	RTM0614-05	26.25				
	RTM0614-10	25.25				
	RTM0619-01	28.50				
1-3/16	RTM0619-03	27.50				

OD	Taper OD	Tap Size	Taper Length ML	Male Length M	Catalog Number	Price	
3/4	1/2	1/4-20 thread	9/32	1-3/16	RTM0619-05	26.50	
					RTM0619-10	25.50	
				1-3/8	RTM0622-01	28.75	
					RTM0622-03	27.75	
					RTM0622-05	26.75	
					RTM0622-10	25.75	
1	5/8	1/4-20 thread	11/32	11/16	RTM0811-01	29.00	
					RTM0811-03	28.00	
					RTM0811-05	27.00	
					RTM0811-10	26.00	
				7/8	RTM0814-01	29.25	
					RTM0814-03	28.25	
					RTM0814-05	27.25	
				7/8	RTM0814-10	26.25	
					1-3/16	RTM0819-01	29.50
						RTM0819-03	28.50
RTM0819-05	27.50						
1-3/8	RTM0819-10	26.50					
	RTM0822-01	29.75					
	RTM0822-03	28.75					
1-3/8	RTM0822-05	27.75					
	RTM0822-10	26.75					
	1-1/2	1	5/16-18 thread	1/2	1-1/8	RTM1218-10	33.00
1-3/8					RTM1222-10	33.25	
1-5/8					RTM1226-10	33.50	
2	1-1/2	5/16-18 thread	1/2	1-1/8	RTM1618-10	43.00	
				1-3/8	RTM1622-10	43.25	
				1-5/8	RTM1626-10	43.50	

Prices subject to change without notice

Also Available - Custom Taper Locks manufactured to your specifications