

US Inch Ejector Blades

H-13 Steel

- 50-52 Rc Core Hardness
- One piece design for strength & accuracy
- Annealed Heads
- Etched for easy identification
- Special sizes available by request
- Manufactured In-House for cost effective, rapid delivery

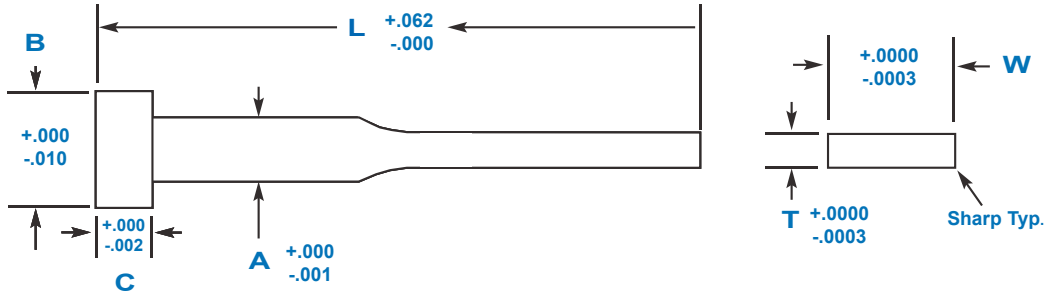

Pin Dia A	Head		Blade		Lengths		Catalog Number
	Dia B	Thick C	Thick T	Width W	Blade F	Overall L	
1/8	1/4	1/8	.0240	.1000	4-3/8	6-3/8	B1252446
					3	5	B1253235
					3	6	B1253236
					4-3/8	6-3/8	B1253246
					4-3/8	7-3/8	B1253247
			.0320	.1000	3	5	B1254635
					3	6	B1254636
					4-3/8	6-3/8	B1254646
					4-3/8	7-3/8	B1254647
					4-3/8	8-3/8	B1254648
5/32	9/32	5/32	.0240	.1400	4-3/8	6-3/8	B1562446
					3	6	B1563236
					4-3/8	6-3/8	B1563246
					4-3/8	8-3/8	B1563248
					4-3/8	8-3/8	B1564646
			.0320	.1400	3	6	B1564636
					4-3/8	6-3/8	B1564646
					4-3/8	8-3/8	B1564648
					4-3/8	8-3/8	B1564648
					4-3/8	8-3/8	B1564648
3/16	3/8	3/16	.0240	.1720	4-3/8	6-3/8	B1872446
					3	6	B1873236
					4-3/8	6-3/8	B1873246
					4-3/8	7-3/8	B1873247
					4-3/8	7-3/8	B1873247
			.0320	.1720	3	6	B1874636
					4-3/8	6-3/8	B1874646
					4-3/8	7-3/8	B1874647
					4-3/8	7-3/8	B1874647
					4-3/8	7-3/8	B1874647
1/4	7/16	3/16	.0240	.1720	4-3/8	6-3/8	B1872446
					3	6	B1873236
					4-3/8	6-3/8	B1873246
					4-3/8	7-3/8	B1873247
					4-3/8	7-3/8	B1873247
			.0320	.1720	3	6	B1874636
					4-3/8	6-3/8	B1874646
					4-3/8	7-3/8	B1874647
					4-3/8	7-3/8	B1874647
					4-3/8	7-3/8	B1874647
1/4	7/16	3/16	.0240	.1720	4-3/8	6-3/8	B1872446
					3	6	B1873236
					4-3/8	6-3/8	B1873246
					4-3/8	7-3/8	B1873247
					4-3/8	7-3/8	B1873247
			.0320	.1720	3	6	B1874636
					4-3/8	6-3/8	B1874646
					4-3/8	7-3/8	B1874647
					4-3/8	7-3/8	B1874647
					4-3/8	7-3/8	B1874647

Pin Dia A	Head		Blade		Lengths		Catalog Number		
	Dia B	Thick C	Thick T	Width W	Blade F	Overall L			
1/4	7/16	3/16	.0460	.2340	3	5	B2504635		
					3	6	B2504636		
					4-3/8	6-3/8	B2504646		
					4-3/8	7-3/8	B2504647		
					4-3/8	8-3/8	B2504648		
					.0620	.2340	3	5	B2506235
							3	6	B2506236
							4-3/8	6-3/8	B2506246
							4-3/8	8-3/8	B2506248
							4-3/8	8-3/8	B2506248
5/16	1/2	1/4	.0320	.2970	4-3/8	6-3/8	B3123246		
					4-3/8	7-3/8	B3123247		
					4-3/8	6-3/8	B3124646		
					4-3/8	8-3/8	B3124648		
					4-3/8	8-3/8	B3124648		
			.0460	.2970	4-3/8	6-3/8	B3126246		
					4-3/8	7-3/8	B3126247		
					4-3/8	6-3/8	B3127846		
					4-3/8	7-3/8	B3127847		
					4-3/8	8-3/8	B3127848		
3/8	5/8	1/4	.0320	.3590	4-3/8	6-3/8	B3753246		
					4-3/8	7-3/8	B3753247		
					4-3/8	9-3/8	B3753249		
					4-3/8	6-3/8	B3754646		
					4-3/8	7-3/8	B3754647		
			.0460	.3590	4-3/8	6-3/8	B3756246		
					4-3/8	7-3/8	B3756247		
					4-3/8	6-3/8	B3756246		
					4-3/8	7-3/8	B3756247		
					4-3/8	7-3/8	B3756247		
1/2	3/4	1/4	.0620	.4840	5-3/8	8-3/8	B5006258		
					5-3/8	8-3/8	B5007858		
					5-3/8	9-3/8	B5007859		
					5-3/8	10-3/8	B50078510		
					5-3/8	10-3/8	B50078510		
			.0780	.4840	5-3/8	8-3/8	B5007858		
					5-3/8	9-3/8	B5007859		
					5-3/8	9-3/8	B5007859		
					5-3/8	10-3/8	B50078510		
					5-3/8	10-3/8	B50078510		