

- Spherical Radius on Head allows installation without extra machining on the head
- Precision ground shanks provide the press fit necessary for secure installation
- Smooth surface with non-galling surface treatment eliminates wear
- Made from High Tinsel Strength Steel and treated for Lubricity

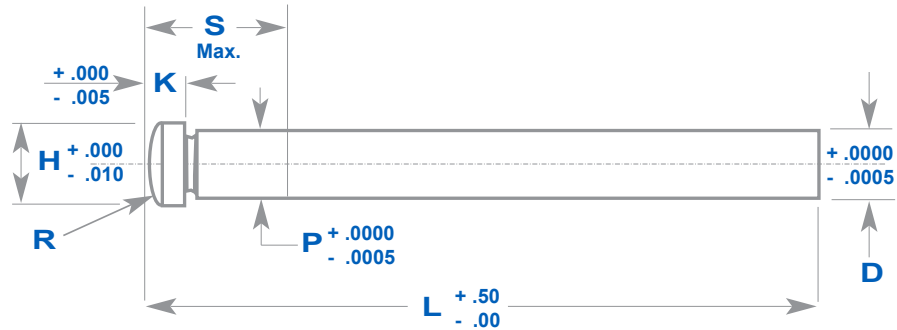

Diameter	Step Diameter	Head Diameter	Head Thickness	Head Radius	Overall Length	Step Length	Catalog Number	List Price
D	P	H	K	R	L	S		
.374	.377	.500	.250	3/8	6.00	7/8	AP03706	12.00
					10.00	1-3/8	AP03710	13.00
.499	.502	.625	.250	1/2	6.00	7/8	AP05006	13.00
					10.00	1-3/8	AP05010	18.00
.624	.627	.750	.250	5/8	6.00	7/8	AP06306	13.50
					10.00	1-3/8	AP06310	18.00
.749	.752	.875	.312	3/4	10.00	1-3/8	AP07510	26.00
					14.00	1-3/8	AP07514	45.00

Prices subject to change without notice

Installation Instructions:

Notes:

* Diameter dimension specified for hole will provide approximately .000 to .001 clearance with the "P" diameter to press fit area of the pins. Moldmaker to adjust "D" diameter hole dimensions to obtain specific fit required.

Cut angle pin to length as required to achieve desired travel on slide. Typically, a spherical radius or cone shape with a spherical radius is machined on end of angle pin (opposite the head)

Spherical radius on head is suitable for angles up to and including 20 degrees.

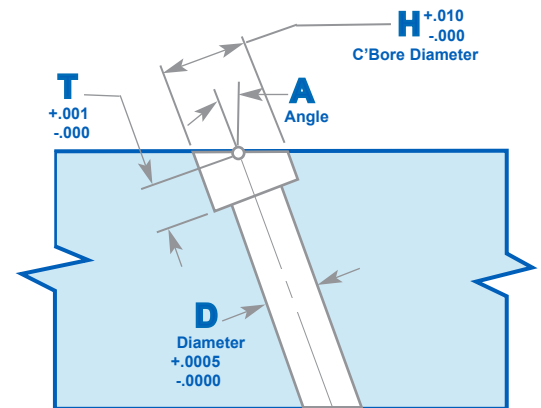

Dia	D*	A	T	H
3/8	*.3765	10*	.256	.562
		15*	.264	
		20*	.275	
1/2	*.5015	10*	.258	.688
		15*	.268	
		20*	.283	
5/8	*.6265	10*	.260	.812
		15*	.273	
		20*	.291	
3/4	*.7515	10*	.324	.938
		15*	.339	
		20*	.361	